

Conjunto Dobradiça S65 105° Soft Clip ACT3



Componente

Item	Componente	Quant.
1	Dobradiça	01
2	Calço	01

Dados do Produto

Fixação Calço-Dobradiça	Clip-on
Ângulo de Abertura	105°
Mola	com amortecimento
Furação Caneco	Ø35x11.5
Entre Furos Caneco	48mm
Distância Fixação Calço	37mm
Entre Furos Calço	32mm
Fixação	com parafusos / com bucha (opcional)

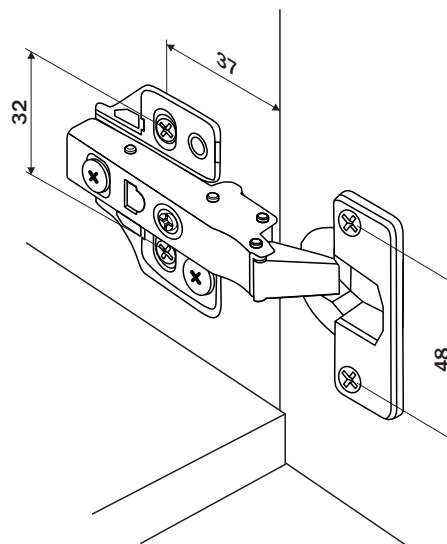

A6507NI Corpo Baixo

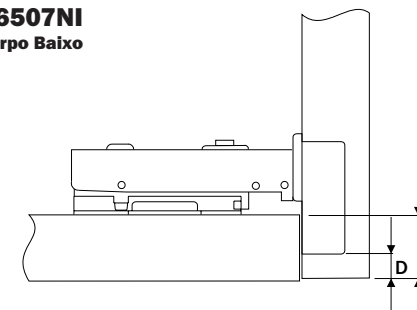

D	S
3	18
4	19
5	20
6	21

Referência dobradiças peso/altura

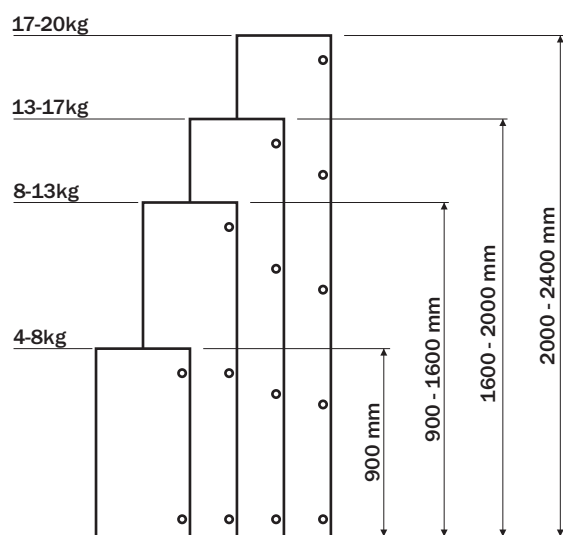

Valores de referência para portas com largura máxima de 600mm

Regulagens

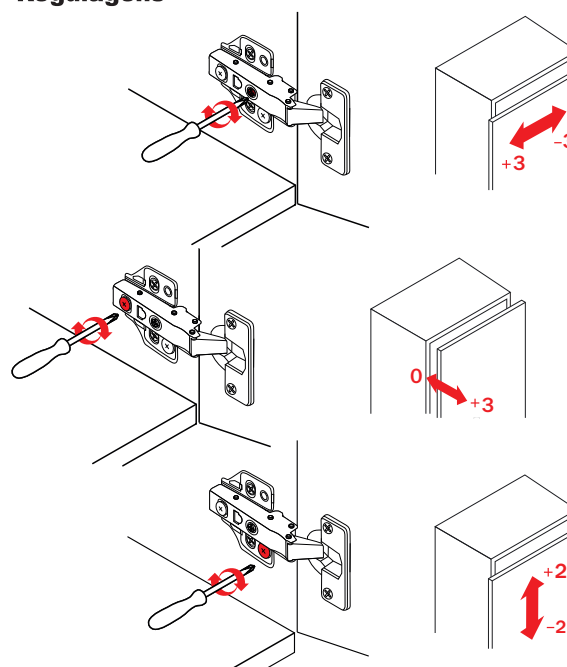

Recomenda-se que as regulagens necessárias para o alinhamento da porta sejam igualmente distribuídas entre todas as dobradiças, alcançando assim o balanceamento dos esforços entre elas.

A6547NI Corpo Alto

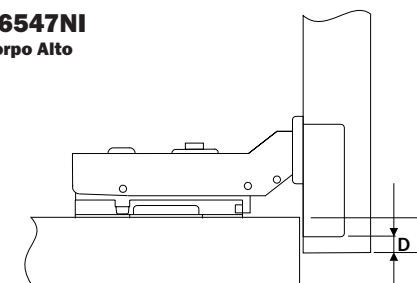

D	S
3	6
4	7
5	8
6	9

A6567NI Corpo Extra Alto

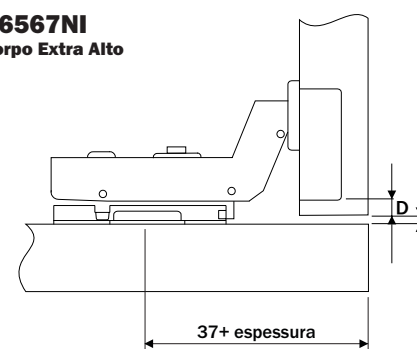

D	F
3	0
4	1
5	2
6	3

Conjunto Dobradiça S65 105° Soft Clip ACT3



Furação

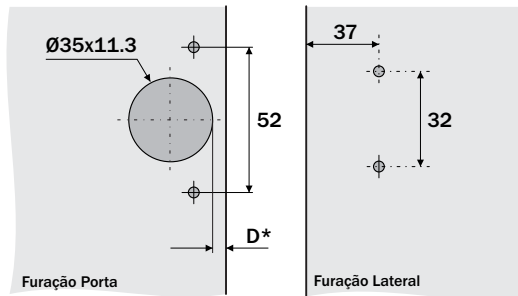

*Conforme Tabela pg 01

Pré - Montagem

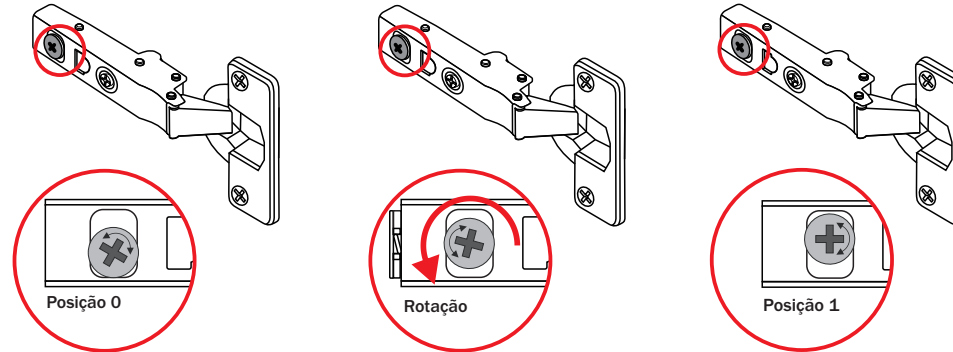

Para facilitar a montagem (dobradiça / calço) rotacione suavemente o parafuso de regulagem de profundidade horizontal no sentido anti-horário, da posição 0 (original) até a posição 1.

! Posição 0 e 1 são posições limites da regulagem. O giro do parafuso além destes pontos causará o rompimento do sistema. (anti-horário conforme posição do desenho)

Regulagem

A Horizontal (Recobrimento)

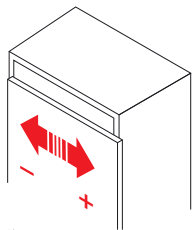
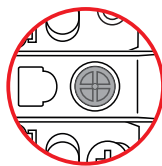
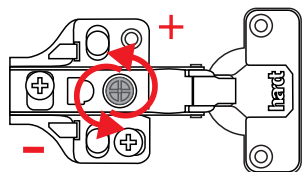

B Profundidade (Distância entre a porta e o armário)

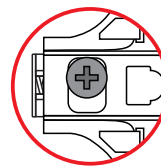
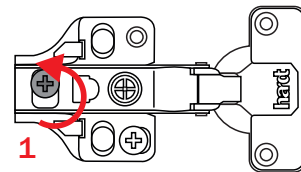
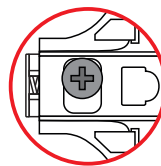
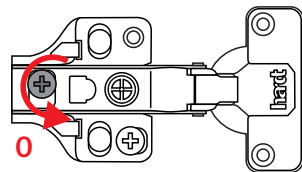

C Vertical

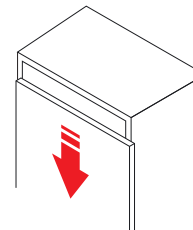
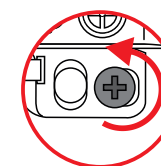
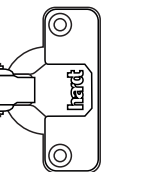
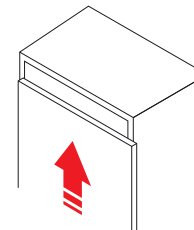
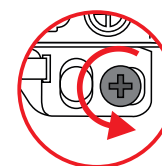
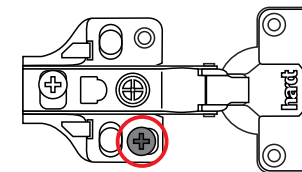

! Posição 0 e 1 do parafuso são posições limites da regulagem. O giro além destes pontos causará o rompimento do sistema. (anti-horário conforme posição do desenho)

Montagem do CLIP

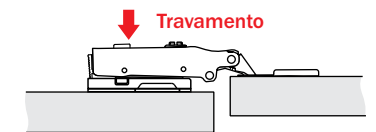
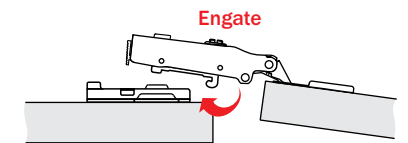

Desmontagem do CLIP

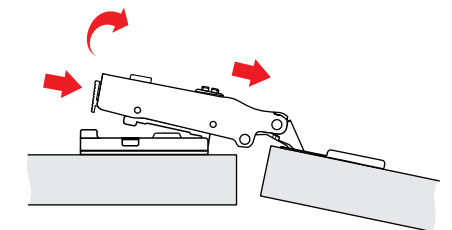

! Para a desmontagem posicione o parafuso de regulagem horizontal na posição 0.