

# Conjunto Dobradiça S95 98° Soft Clip ACT3

# hardt

## Componente

| Item | Componente               | Quant. |
|------|--------------------------|--------|
| 1    | Dobradiça                | 01     |
| 2    | Calço                    | 01     |
| 3    | Arremates Corpo / Caneco | 01     |
| 4    | Parafusos                | 05     |

## Dados do Produto

|                         |                                      |
|-------------------------|--------------------------------------|
| Fixação Calço-Dobradiça | Clip-on                              |
| Ângulo de Abertura      | 98°                                  |
| Mola                    | com amortecimento                    |
| Furação Caneco          | Ø35x11.5                             |
| Entre Furos Caneco      | 52mm                                 |
| Distância Fixação Calço | 37mm                                 |
| Entre Furos Calço       | 32mm                                 |
| Fixação                 | com parafusos / com bucha (opcional) |

## Referência dobradiças peso/altura

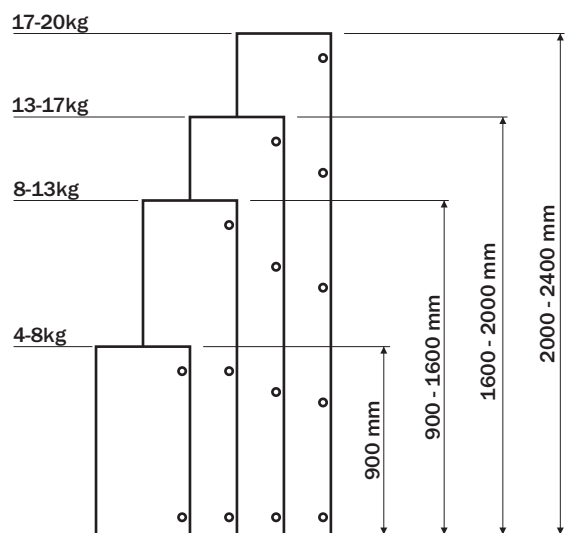

Valores de referência para portas com largura máxima de 600mm

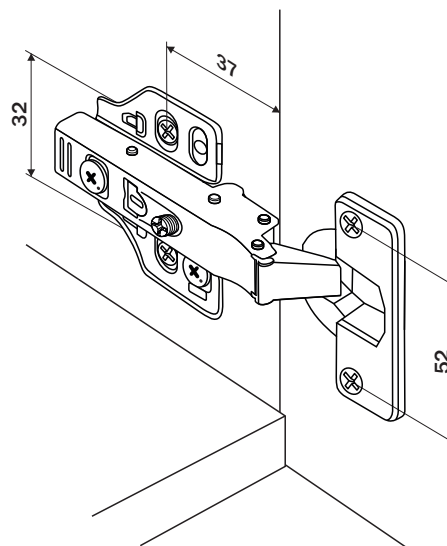

## Regulagens

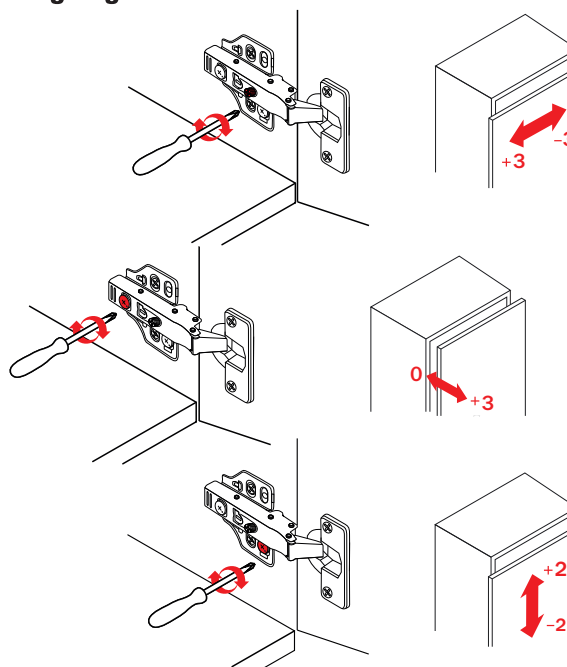

Recomenda-se que as regulagens necessárias para o alinhamento da porta sejam igualmente distribuídas entre todas as dobradiças, alcançando assim o balanceamento dos esforços entre elas.

## A9503NP Corpo Baixo

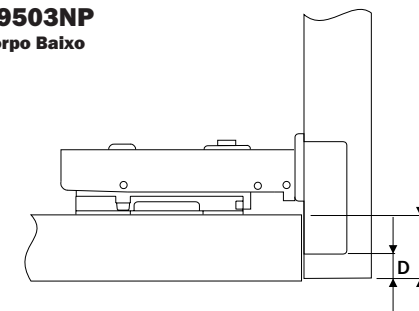

| D | S  |
|---|----|
| 3 | 18 |
| 4 | 19 |
| 5 | 20 |
| 6 | 21 |

## A9543NP Corpo Alto

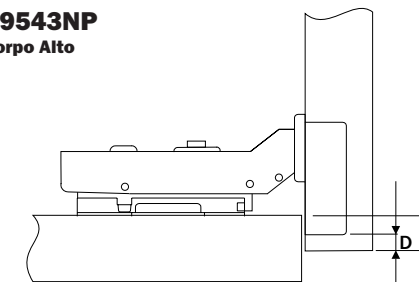

| D | S  |
|---|----|
| 3 | 8  |
| 4 | 9  |
| 5 | 10 |
| 6 | 11 |

## A9563NP Corpo Extra Alto

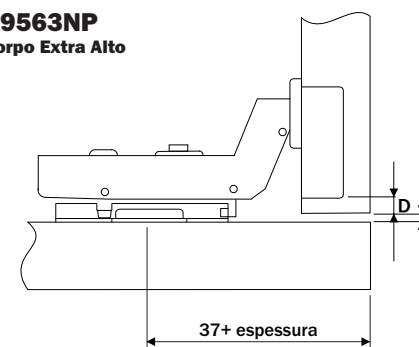

| D | F  |
|---|----|
| 3 | 0  |
| 4 | -1 |
| 5 | -2 |

# Conjunto Dobradiça S95 Soft Clip ACT3



## Furação

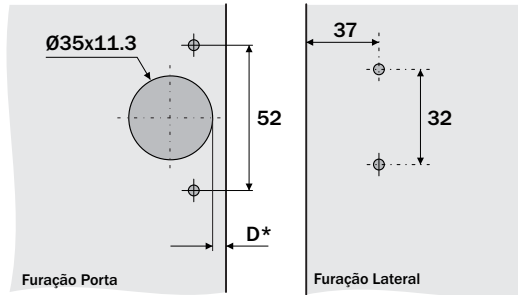

\*Conforme Tabela pg 01

## Pré - Montagem

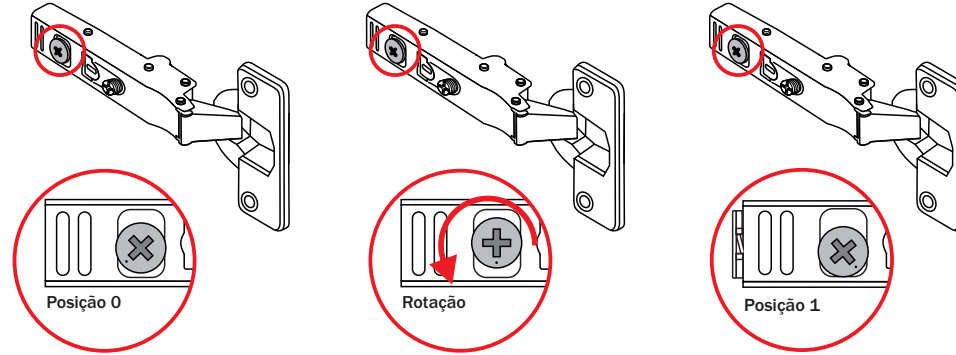

Para facilitar a montagem (dobradiça / calço) rotacione suavemente o parafuso de regulagem de profundidade horizontal no sentido anti-horário, da posição 0 ( original ) até a posição 1.

**!** Posição 0 e 1 são posições limites da regulagem. O giro do parafuso além destes pontos causará o rompimento do sistema. ( anti-horário conforme posição do desenho )

**!** A fixação da dobradiça e do calço devem ser feitas de forma independente.

## Regulagem

### A Horizontal ( Recobrimento )

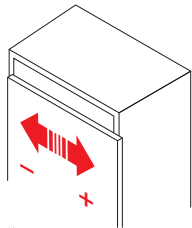
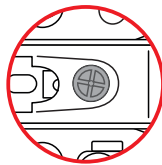
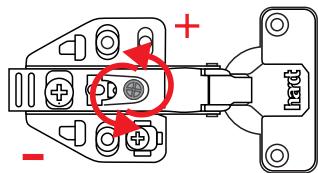

### B Profundidade ( Distância entre a porta e o armário )

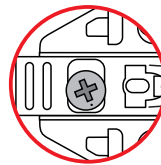
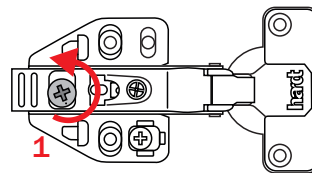
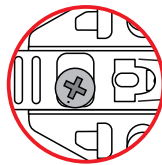
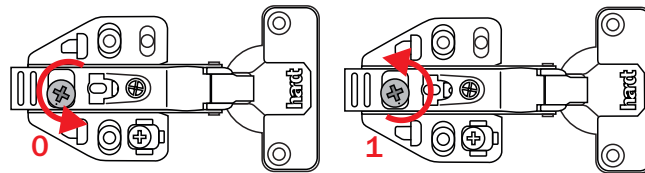

### C Vertical

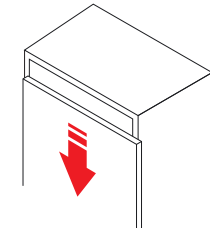
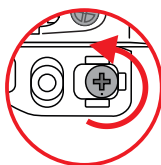
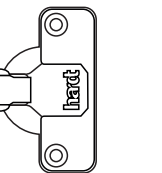
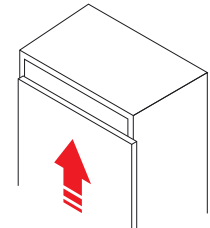
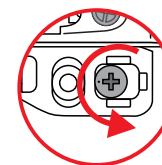
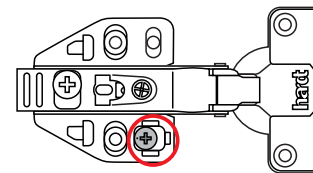

**!** Posição 0 e 1 do parafuso são posições limites da regulagem. O giro além destes pontos causará o rompimento do sistema. ( anti-horário conforme posição do desenho )

## Montagem do CLIP

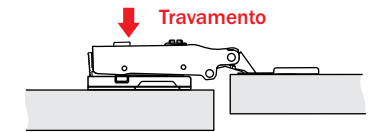
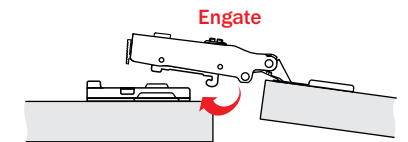

## Desmontagem do CLIP

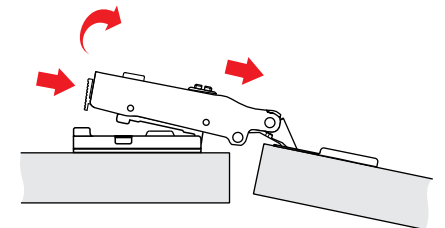

**!** Para a desmontagem posicione o parafuso de regulagem horizontal na posição 0.